

TWO YEAR LIMITED WARRANTY PROGRAM

This limited warranty program is the only one that applies to this product, and it sets forth all the responsibilities of Vector Manufacturing, regarding this product. There is no other warranty, other than those described herein. Any implied warranty of merchantability or fitness for a particular purpose on this product is limited in duration to the duration of this warranty.

This Vector Manufacturing product is warranted, to the original purchaser only, to be free of defects in materials and workmanship for two years from the date of purchase without additional charge. The warranty does not extend to subsequent purchasers or users. Manufacturer will not be responsible for any amount of damage in excess of the retail purchase price of the product under any circumstances. Incidental and consequential damages are specifically excluded from coverage under this warranty.

This product is not intended for commercial use. This warranty does not apply to damage to units from misuse or incorrect installation/connection. Misuse includes wiring or connecting to improper polarity power sources.

RETURN/REPAIR POLICY: Defective products may be returned to manufacturer. Any defective product that is returned to manufacturer within 30 days of the date of purchase will be replaced free of charge. If such a product is returned more than 30 days but less than two years from the purchase date, manufacturer will repair the unit or, at its option, replace it, free of charge.

If the unit is repaired, new or reconditioned replacement parts may be used, at manufacturer's option. A unit may be replaced with a new or reconditioned unit of the same or comparable design. The repaired or replaced unit will then be warranted under the terms of the remainder of the warranty period. The customer is responsible for the shipping charges on all returned items. During the warranty period, manufacturer will be responsible for the return shipping charges to the customer in the United States.

LIMITATIONS: This warranty does not cover accessories, such as charging adapters, bulbs, fuses and batteries, damage or defects resulting from normal wear and tear (including chips, scratches, abrasions, discoloration or fading due to usage or exposure to sunlight), accidents, damage during shipping to our service facility, alterations, unauthorized use or repair, neglect, misuse, abuse, failure to follow instructions for care and maintenance, fire, flood and Acts of God.

If your problem is not covered by this warranty, call our Technical Support Department toll free at (800) 618-5178 for general repair information and charges if applicable. You may also contact us through our website at www.vectormfg.com.

STATE LAW RIGHTS: This warranty gives you specific legal rights. Some states do not allow limitations on how long an implied warranty lasts or the exclusion or limitation of incidental or consequential damages, so the exclusions or limitations stated herein may not apply. This warranty gives the purchaser specific legal rights; other rights, which vary from state to state, may apply.

TO REQUEST WARRANTY SERVICE FOR THIS PRODUCT: Contact Technical Support by telephone, fax or mail (see below). We suggest that you keep the original packaging in case you need to ship the unit. When returning a product, include your name, address, phone number, dated sales receipt (or copy) and a description of the reason for return and product serial number. After repairing or replacing the unit, we will make every effort to return it to you within four weeks.

WARRANTY ACTIVATION: Please complete Warranty Activation Card and mail to Vector Manufacturing. Enter "VEC158BD" as Model and "3,000,000 Power Series" Twin-Beam Spotlight" as Product Type. All Vector products must be registered within 30 days of purchase to activate this warranty. Mail the completed registration form, along with a copy of the original sales receipt, to:

ATTN.: CUSTOMER SERVICE
4140 SW 30th Ave., Ft. Lauderdale, FL 33312
• TOLL FREE: (800) 618-5178 • FAX: (954) 584-5556 •

WARRANTY IS NON-TRANSFERABLE.

BD080905

© 2005 VECTOR MANUFACTURING
MADE IN CHINA

VEC158BD

BLACK & DECKER

Twin-Beam Spotlight

3,000,000 Power Series™

Corded • Cordless • Rechargeable



USER'S MANUAL & WARRANTY INFORMATION

IMPORTANT SAFETY INFORMATION, SAVE THESE INSTRUCTIONS

TO REDUCE THE RISK OF INJURY, USER MUST READ AND UNDERSTAND THIS INSTRUCTIONAL MANUAL. THIS MANUAL CONTAINS IMPORTANT INFORMATION REGARDING THE OPERATION AND WARRANTY OF THIS PRODUCT. PLEASE RETAIN FOR FUTURE REFERENCE.

4140 S.W. 30th Ave., Ft. Lauderdale, FL 33312 U.S.
Toll Free: (800) 618-5178

www.vectormfg.com

IMPORTANT SAFETY INFORMATION

WARNINGS

- **Contains non-spillable sealed lead acid batteries. They must be recycled or disposed of properly.**
- **DO NOT dispose of batteries in fire, as this may result in an explosion.**
- **DO NOT open battery or short circuit, this may cause the battery to leak or get hot causing personal injury. Any disposal questions call toll-free (877) 288-7722.**
- **RISK OF FIRE/ELECTRIC SHOCK — do not plug in a power supply without the bulb lens and cover in place.**
- **ALL HALOGEN LIGHTS GIVE OFF HEAT.**
 - **Do not touch lens while operating.**
 - **Keep combustibles away from Spotlight lens. Extreme heat can cause fires.**
 - **Never place the light face-down on any surface when lit.**

CAUTIONS

- Never look directly into the light or shine the light into another person's eyes.
- Keep sharp objects away from lens — it is glass and can break.
- Do not immerse spotlight in water.
- Do not drop or throw spotlight. It contains glass and a sealed lead acid battery.
- Only replace bulbs with type indicated in specifications (12 volt, H3 quartz halogen. 75 watt).
- Use only with AC or DC charging adapters that are provided with unit.
- **DO NOT OVERCHARGE:**
 - AC recharge up to 30 hours maximum.
 - DC recharge up to 4 hours maximum.
 - After recharge, disconnect charging adapter and wait 5 minutes before use.
- **NEVER ATTEMPT TO USE THE AC CHARGER AND DC CHARGING PORT SIMULTANEOUSLY.**
- Do not crush, cut, pull or expose charging adapter cords to extreme heat.
- Position charging adapter cords so they do not become entangled or become a safety hazard. Keep charging adapter cords away from sharp edges.
- Use in a dry location only.
- Do not open body casing. There are no user-serviceable parts inside.

THIS UNIT IS NOT A TOY AND SHOULD ONLY BE OPERATED BY ADULTS. KEEP AWAY FROM CHILDREN!

Read This User's Manual Before Using This Spotlight.

SAVE THESE INSTRUCTIONS

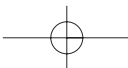

TABLE OF CONTENTS

Introduction	1
Features	1
Charging/Recharging the Spotlight	2
Charging Using the 120 Volt AC Recharge Port	3
Charging Using the 12 Volt DC Charging Adapter	3
Operating Instructions	4
Operating the Spotlight and LED Area Lights	4
Using the 12 Volt DC Accessory Outlet	4
Care and Maintenance	4
Spotlight Bulb Replacement	4
Battery Replacement/Disposal	6
DC Plug Fuse Replacement	6
Troubleshooting	6
Charging Issues	6
Operating Issues	7
Specifications	7

INTRODUCTION

Thank you for purchasing the **Black & Decker 3,000,000 Power Series™ Twin-Beam Spotlight**. Please read this guide carefully before use to ensure optimum performance and to avoid damage to the unit.

FEATURES

- Two powerful, focused, replaceable quartz halogen bulbs
- Two magnified LED Area Lights
- Three-position Light Mode Switch selects single Spotlight, dual Spotlight or LED Area Lights
- Spotlight ON/OFF Trigger with Trigger Guard
- 12 Volt DC Accessory Outlet
- Protective rubber safety guard (bezel) around lens
- Rubber safety cap protects battery compartment
- Comfortable pistol grip handle
- Battery Status LED Indicator displays battery charge level while charging, or whenever Battery Status Pushbutton is pressed
- UL listed, built-in 120 Volt AC Charger
- 12 Volt DC Charging/Power Adapter included
- Rechargeable, non-spillable, sealed lead acid battery

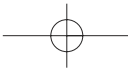

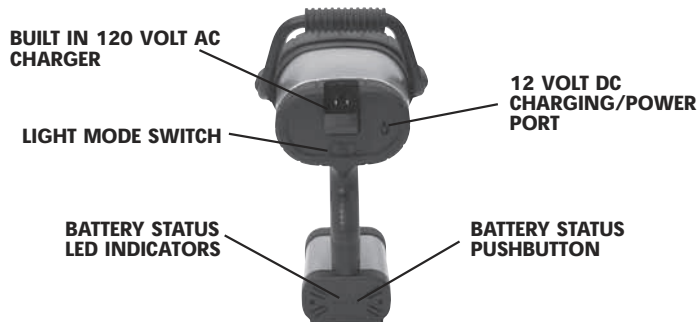

CHARGING/RECHARGING THE SPOTLIGHT

This unit is shipped in a partially charged state. BEFORE first use, charge the Spotlight using the 120 Volt AC Charger for 20-30 hours or until the green LED Indicator lights. To check the battery charge status at any time, press the Battery Status Pushbutton. The LED Indicators display the level of charge. Three red LEDs indicate a high level of charge; two, a medium level; and one red LED indicates that the unit should be charged soon.) The green LED lights to show a fully charged unit.



It is recommended that you charge the Spotlight after each use (or every 2 months when not in frequent use) until the green LED lights so the unit is always ready when you need it.

Charging Using the 120 Volt AC Charger

- Plug a standard North American 120 volt AC extension cord into the 120 Volt AC Charger on the back of the unit.



HOUSEHOLD EXTENSION CORD (NOT INCLUDED)



BUILT-IN 120 VOLT AC CHARGER

- Turn OFF the Area Lights and Spotlight (Light Mode Switch is not set to "AREA" and the Trigger is not depressed). Disconnect any 12 volt DC appliances from the 12 Volt DC Accessory Outlet.
- Charge until the Battery Status LED Indicator green LED lights (approximately 20-30 hours). DO NOT CHARGE FOR LONGER THAN 30 HOURS.
- Once recharging is completed, disconnect the adapter from the external charging source.
- After AC recharging, wait 5 minutes before using the Spotlight.

⚠ CAUTION

Do not turn on any lights or operate any appliances through the Spotlight's DC Accessory Outlet when using the 120 Volt AC Charger.

Charging Using the 12 Volt DC Charging Adapter

Make sure the DC source (jump-starter, battery pack, vehicle accessory outlet, etc.) is 12 volt DC and is able to supply at least one half amp at 12 volt DC for 8 hours. This means a battery pack should be charged with at least 4 amp hours capacity.

The **VEC158BD** can be simultaneously charged and operated from a 12 volt DC source. **Make sure the 12 volt DC source can supply minimum 15 amps of current if the Spotlight is to be operated while the batteries are being charged.**

- Insert the 12 volt DC plug end of the 12 Volt DC Charging/Power Adapter into the accessory outlet of your vehicle or other 12 volt DC power source.



12 VOLT DC CHARGING/POWER ADAPTER (INCLUDED)



12 VOLT DC CHARGING/POWER PORT

- Plug the barrel-tip end into the 12 Volt DC Charging/Power Port on the back of the unit.
- Charge until the Battery Status LED Indicator green LED lights when the Battery Status Display pushbutton is pressed (approximately 3-4 hours). DO NOT CHARGE FOR LONGER THAN 4 HOURS.
- Once recharging is completed, disconnect the adapter from the external charging/power source.

Note: When using a vehicle's 12 volt DC accessory outlet as a charging source, be aware that some vehicles require you to turn on the ignition to power the accessory outlet.

⚠ WARNING
NEVER ATTEMPT TO USE THE AC CHARGER AND DC CHARGING PORT SIMULTANEOUSLY.

OPERATING INSTRUCTIONS

Operating the Spotlight and LED Area Lights

To use the lights, first set the Light Mode Switch to the desired operation – “SINGLE” Spotlight beam, “TWIN” Spotlight beam or “AREA” for LED Area Lights.

To operate the LED Area Lights, simply slide the switch to select AREA. To turn the LED Area Lights OFF, slide the switch to any other setting.

To operate the Spotlight:

1. Slide the switch to select SINGLE or TWIN beam.
2. Flip up the Trigger Guard (see diagram on page 2).
3. Squeeze the Trigger.

To turn the Spotlight OFF, release the Trigger.



Using the 12 Volt DC Accessory Outlet

Flip up the cover on the 12 Volt DC Accessory Outlet just above the base on the front of the unit. Insert the appliance's DC plug and operate as usual.

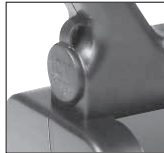

Note: Do not operate the 12 Volt DC Accessory Outlet while charging/recharging using the 120 Volt AC Charger.

CARE AND MAINTENANCE

All batteries lose charge with time, especially when they are warm. Recharge the unit every two months when not in frequent use, preferably using the 120 volt AC method. Never submerge the unit in water. If the unit gets dirty, gently clean the outer surfaces of the spotlight unit with a soft cloth moistened with a mild solution of water and detergent.

The quartz halogen bulbs are the only user-replaceable parts in the Spotlight. Periodically inspect the condition of adapters, connectors and wires. Contact Technical Support toll-free at (800) 618-5178 to replace any components that have become worn or broken.

Spotlight Bulb Replacement

To replace either or both H3 type 12 volt 75 watt bulbs, you will need a small

Phillips type screwdriver and a replacement bulb (or bulbs). During installation, avoid touching the glass part of the bulb. Bulb life may be shortened by installing a bulb with dirt or fingerprints on it. The bulb can be wiped clean with a cloth moistened with alcohol.

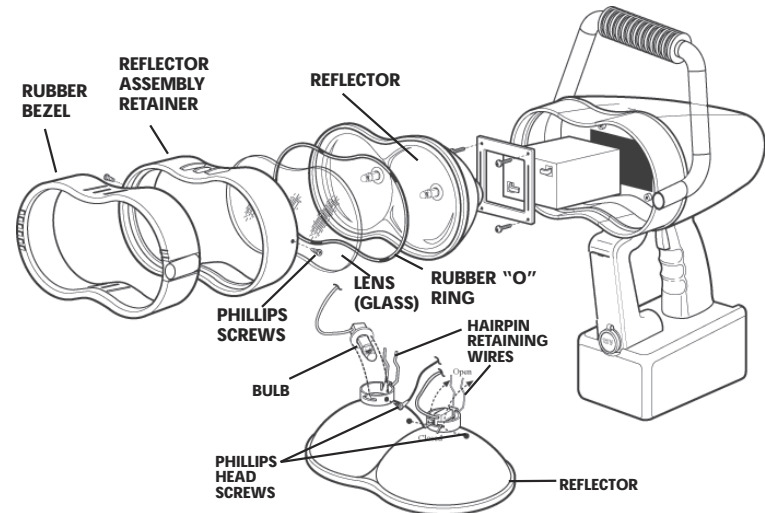

1. Disconnect the unit from any charging adapters.
2. Push the rubber bezel forward toward the front of the spotlight to reveal two small Phillips screws in the retaining ring.
3. Using the screwdriver, remove (counterclockwise) the two screws. Set them aside.
4. Lift off the retaining ring, glass lens and rubber “O” ring and set them aside.
5. Carefully remove the reflector and bulb assembly.
6. Disconnect the bulb wire from the red power wire.
7. Unsnap the hairpin retaining wires from the reflector's flange.
8. Using the screwdriver, loosen the retaining screw to remove the bulb from the reflector (no need to completely remove this screw).
9. Lift out the bulb and detach wire.
10. Insert the replacement bulb into the reflector's flange.
11. Put back and secure the hairpin retaining wires.
12. Connect the bulb power wire to the red power wire.
13. Tighten the retaining screw on the flange.
14. Place the reflector in position in the body of the spotlight.
15. Replace the rubber “O” ring in the groove around the perimeter of the reflector.
16. Replace glass and retaining ring so the screw holes are aligned.
17. Secure retaining ring with two screws.
18. Replace rubber bezel.
19. Operate switch to ensure proper operation of spotlight.

⚠ WARNING

To reduce the risk of electric shock, replace bulbs with 12 volt H3 75 watt only.

Battery Replacement/Disposal**Battery Replacement**

The battery should last the service life of the unit. Contact Technical Support toll-free at (800) 618-5178 for any information you may need.

Safe Battery Disposal

Contains a maintenance-free, sealed, non-spillable, lead acid battery, which must be disposed of properly. Recycling is required, contact your local authority for information. Failure to comply with local, state and federal regulations can result in fines, or imprisonment.

**⚠ WARNINGS**

- Do not dispose of the battery in fire as this may result in an explosion.
- Before disposing of the battery, protect exposed terminals with heavy-duty electrical tape to prevent shorting (shorting can result in injury or fire).
- Do not expose battery to fire or intense heat as it may explode.
- For more information on recycling this battery, call toll-free (877) 288-7722.

12 Volt DC Charging Adapter Plug Fuse Replacement

The fuse in the plug end of the 12 Volt DC Charging Adapter protects the adapter's charging circuit. If the 120 Volt AC Charger operates, but the DC charging adapter does not, then this fuse may be opened (blown).

To replace the fuse:

1. Unscrew the end cap of the DC plug (counterclockwise).
2. Remove spring center contact and fuse.
3. Check fuse with a continuity checker.
4. If blown, locate a replacement 8 amp/250 volt fuse.
5. Replace the fuse, spring, contact and end cap.
6. Screw end cap clockwise until it is finger tight – DO NOT OVER-TIGHTEN.
7. Test for proper operation of the 12 Volt DC Charging Adapter.

TROUBLESHOOTING**Charging Issues****No Battery Status Indicator LEDs Light When Charging**

1. Check connection to the 120 Volt AC Charger or 12 Volt DC Charging Port.
2. Check connection to AC or DC power source.
3. Confirm there is a functioning AC or DC current.

Operating Issues**The Area Light is operating, but the Spotlight is not.**

- SINGLE or TWIN must be selected on the Light Mode Switch **and** the Trigger depressed to operate the Spotlight.
- The Spotlight will not operate while charging using the 120 volt AC method. Be sure all extension cords are disconnected from the AC charger before Spotlight use. (The Spotlight can be operated while charging using the 12 volt DC method.)
- If you suspect the bulb is blown, check the filament. If the filament is coiled and unbroken, the bulb is not blown. If bulb is blown, replace it.

None of the lights are operating.

- The battery may be completely discharged. Charge the unit following the directions on page 2.
- If the unit does not operate after recharging as directed, contact Technical Support toll-free at (800) 618-5178.

SPECIFICATIONS

Spotlight Bulb:	Dual 12 volt, H3 series, 75 watt
Battery:	Two maintenance-free, sealed lead acid, 6 volt, 6.0 amp hour
AC Charger:	UL Listed, Class 2, 12 volt DC (300 mA)
DC Plug Fuse	8A/250 V